

Previous Screen

Tooling Options

Table of Contents

Metric Huck-Spin®

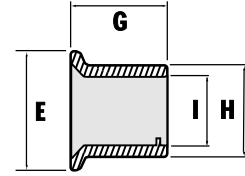
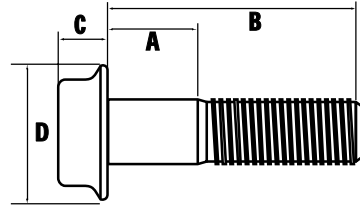

Round Head Metric

Fastener Dimensions

14mm Round Head (DT14)			
	Grip No.	A	B
C=	11.50	-10	4.0 54.42
D=	30.00	-15	9.0 59.42
E=	31.00	-20	14.0 64.42
G=	21.80	-25	19.0 69.42
H=	23.30	-30	24.0 74.42
I=	14.60	-35	29.0 79.42
		-40	34.0 84.42
		-45	39.0 89.42
		-50	44.0 94.42
		-55	49.0 99.42
		-60	54.0 104.42
		-65	59.0 109.42
		-70	64.0 114.42
		-75	69.0 119.42

Fastener Dimensions

16mm Round Head (DT16)			
	Grip No.	A	B
C=	12.80	10	4.0 54.41
D=	24.10	15	9.0 59.41
E=	34.80	20	14.0 64.41
G=	23.40	25	19.0 69.41
H=	25.60	30	24.0 74.41
I=	16.46	35	29.0 79.41
		40	34.0 84.41
		45	39.0 89.41
		50	44.0 94.41
		55	49.0 99.41
		60	54.0 104.41
		65	59.0 109.41
		70	64.0 114.41

Fastener Dimensions

20mm Round Head (DT20)			
	Grip No.	A	B
C=	16.10	-15	9.0 68.24
D=	30.10	-20	14.0 73.24
E=	43.05	-25	19.0 78.24
G=	28.80	-30	24.0 83.24
H=	32.10	-35	29.0 88.24
I=	20.45	-40	34.0 93.24
		-45	39.0 98.24
		-50	44.0 103.24
		-55	49.0 108.24
		-60	54.0 113.24
		-80	74.0 133.25

Hex Head Metric

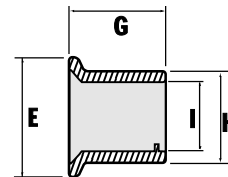
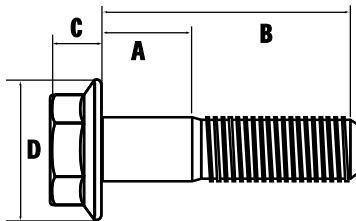

16mm Hex Head (DT16)

	Grip No.	A	B
C=	15.10	10	4.0 59.54
D=	32.80	15	9.0 64.54
E=	21.00	17	10 67.54
G=	28.98	20	14.0 69.54
H=	26.00	25	19.0 74.54
I=	16.10	30	24.0 79.54
		35	29.0 84.54
		40	34.0 89.54
		45	39.0 94.54
		50	44.0 99.54
		55	49.0 104.54
		60	54.0 109.54
		65	59.0 114.54
		70	64.0 119.54

20mm Hex Head (DT20)

	Grip No.	A	B
C=	17.70	15	9.0 73.68
D=	46.00	20	14.0 78.68
E=	30.00	25	19.0 83.68
G=	33.92	30	24.0 88.68
H=	32.00	35	29.0 93.68
I=	20.34	40	34.0 98.68
		45	39.0 103.68
		50	44.0 108.68
		55	49.0 113.68
		60	54.0 118.68

version 4.0

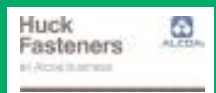

Previous Screen

Tooling Options

Table of Contents

Metric Huck-Spin®

Inspection Data-ROUND HEAD METRIC (MM)

NOMINAL DIA.	A (Max)	B (Max)	C (Min)	D (Max)
DT16	13.76	25.76	17.7	24.1

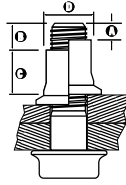

Grip Data

Grip Number	Range (mm) min-max	Grip Number	Range (mm) min-max
10	4 - 6	40	34 - 46
15	9 - 21	45	39 - 51
17	10 - 24	50	44 - 56
20	14 - 26	55	49 - 61
25	19 - 31	60	54 - 66
30	24 - 36	65	59 - 71
35	29 - 41	70	64 - 76

Inspection Data-HEX HEAD METRIC (MM)

NOMINAL DIA.	A (Max)	B (Max)	C (Min)	D (Max)
DT16	17.2	25.76	17.7	24.1
DT20	17.2	29.2	21.2	30.3

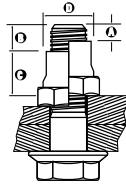

Installation Tooling

Dia.	Installation Tool	Nose Assembly	Type
12mm	HS37	99-7412-1	Hydraulic
14mm	HS52	99-7415-1	Hydraulic
16mm	HS52	99-7315-1	Hydraulic
20mm	HS52	99-7418-1	Hydraulic

Part Number Identification

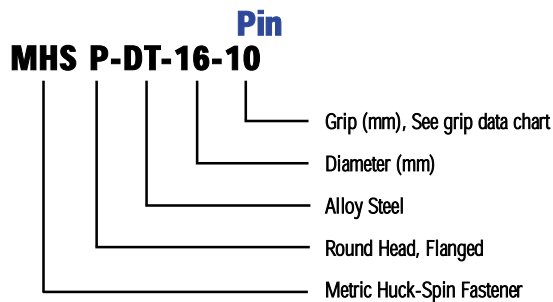

Part Number Identification

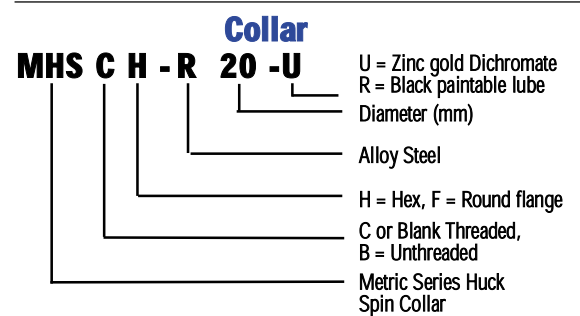

version 4.0

