

Hucktainer® Specialty Fastener

The Hucktainer® fastener is designed to meet the special needs of FRP fabrication. These fasteners install with a consistent pressure that reduces the potential for crushing or crazing FRP panels.

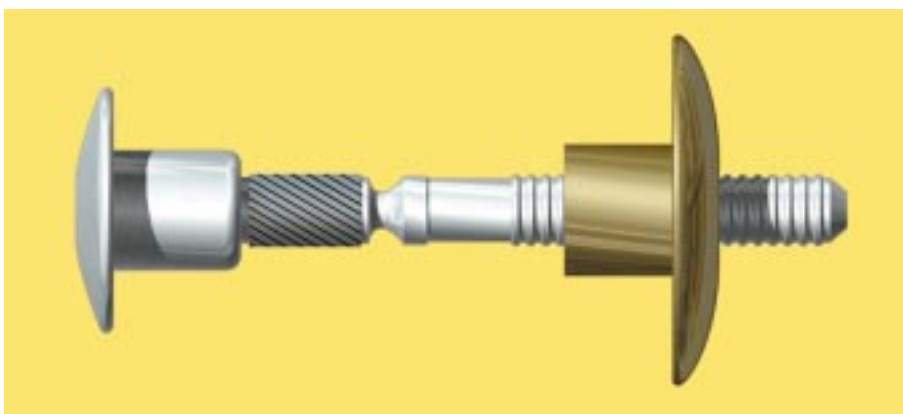

Specifications—Standard Grip

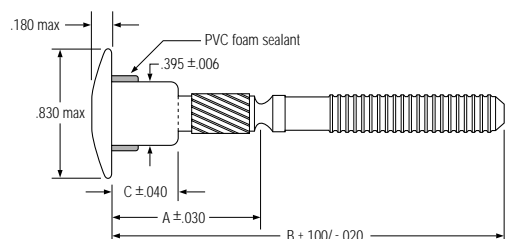

Standard low profile head HLPP-R12-()

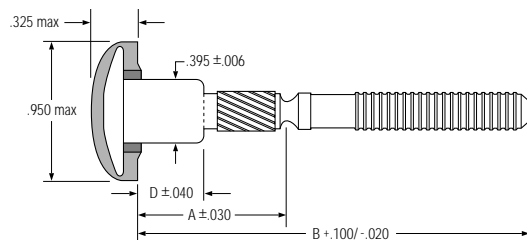

Medium bearing encapsulate head HLPM(*)-R12-()

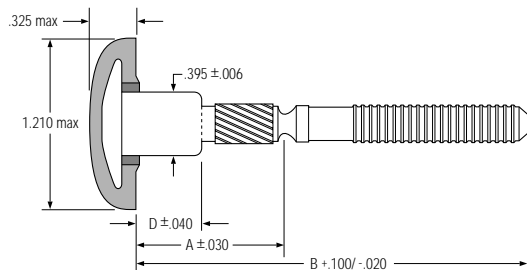

Wide bearing encapsulate head HLPE(*)-R12-()

NOTE: Only wide bearing pin HLPE () and/or wide bearing sleeve HLPS should be used directly against FRP.
Consult factory for stock status—minimums may apply.
Contact your HUCK representative for head styles, grips, and configurations not shown.

Grip Number	Grip Range		Hole Size	A	B	C	D
	min	max					
-9	.500	.625	.405-.421	.562	2.170	**	.015
-10	.562	.687	.405-.421	.624	2.232	.090	.015
-11	.625	.750	.405-.421	.687	2.295	.090	.015
-12	.687	.812	.405-.421	.749	2.357	.220	.145
-13	.750	.875	.405-.421	.812	2.420	.220	.145
-14	.812	.937	.405-.421	.874	2.482	.345	.270
-15	.875	1.000	.405-.421	.937	2.545	.345	.270
-16	.937	1.062	.405-.421	.999	2.607	.470	.395
-17	1.000	1.125	.405-.421	1.062	2.670	.532	.457
-18	1.062	1.187	.405-.421	1.124	2.732	.595	.520
-19	1.125	1.250	.405-.421	1.187	2.795	.658	.583
-20	1.187	1.312	.405-.421	1.249	2.857	.720	.645
-21	1.250	1.375	.405-.421	1.312	2.920	.782	.707
-22	1.312	1.437	.405-.421	1.374	2.982	.782	.707
-23	1.375	1.500	.405-.421	1.437	3.045	.782	.707
-24	1.437	1.562	.405-.421	1.499	3.107	.782	.707
-25	1.500	1.625	.405-.421	1.562	3.170	.782	.707
-26	1.562	1.687	.405-.421	1.625	2.232	.782	.707
-27	1.625	1.750	.405-.421	1.687	3.295	.782	.707
-28	1.687	1.812	.405-.421	1.750	3.357	.782	.707
-29	1.750	1.875	.405-.421	1.812	3.420	.782	.707
-30	1.812	1.937	.405-.421	1.875	3.482	.782	NA

Clearance sleeve HLPSC-R12

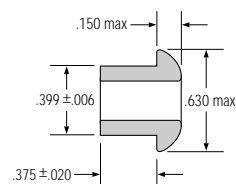

Medium bearing sleeve HLPSM-R12

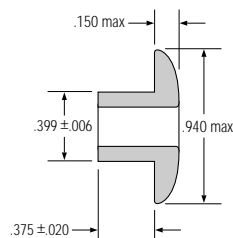

Clearance sleeve HLPS-R12

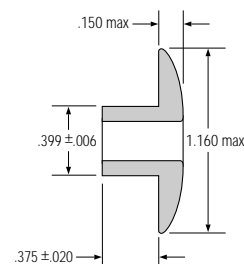

* Add encapsulated color: W = white, G = gray, RY = Ryder yellow, HY = Hertz yellow. Consult HUCK for other colors.

** Available only in encapsulated configuration.

Installed Values in Nominal Grip (lbs.)

Tensile	800 lbs min	1200 lbs typ max grip	1800 lbs typ min grip
Clamp	700 lbs typ		

Material and Finish—Standard Grip

	Material	Finish
Sleeve	Steel	Zinc Plated Gold Chromate
Pin	Steel	Zinc Plated Clear Chromate

Installation Tooling

Installation Tool	Nose Assembly	Type	Use
230	99-3465	Pneudraulic	Maintenance & Repair
2025	99-3465	Pneudraulic	Maintenance & Repair
212	99-3464	Pneudraulic	Production
246	99-3438	Pneudraulic	Production
2480	99-3464	Hydraulic	Production
2580	99-3438	Hydraulic	Production

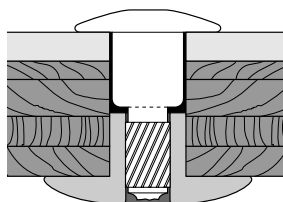
Recommended Installation Configurations

HLPP-R12(-)

HLPS-R12

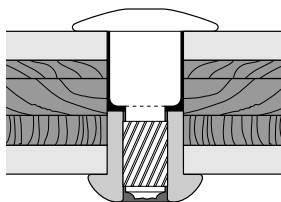

HLPP-R12(-)

HLPSC-R12

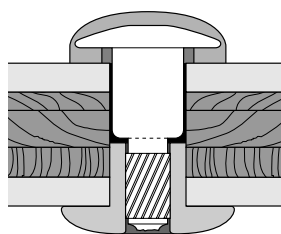

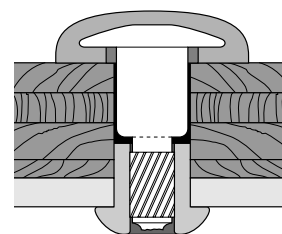

HLPM(-)R12(-)

HLPSC-R12



HLPE(-)R12(-)

HLPSC-R12

 FRP or other clamp sensitive material
 Aluminum, Steel, etc.

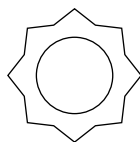
**Pin-Lock**

The Pin-Lock is an option that can be ordered by adding "PL" suffix to the pin part number. The Pin-Lock is a nylon "star" that retains the pin in the hole prior to installation.



Installation Sequence

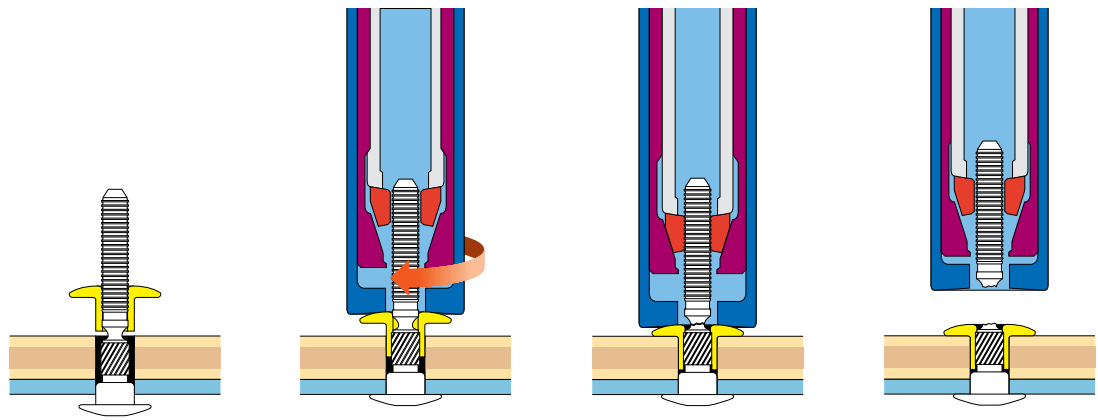

[Click Here to view animation of installation sequence](#)

Part Number Identification - Pin

HLP E W - R 12 - 24

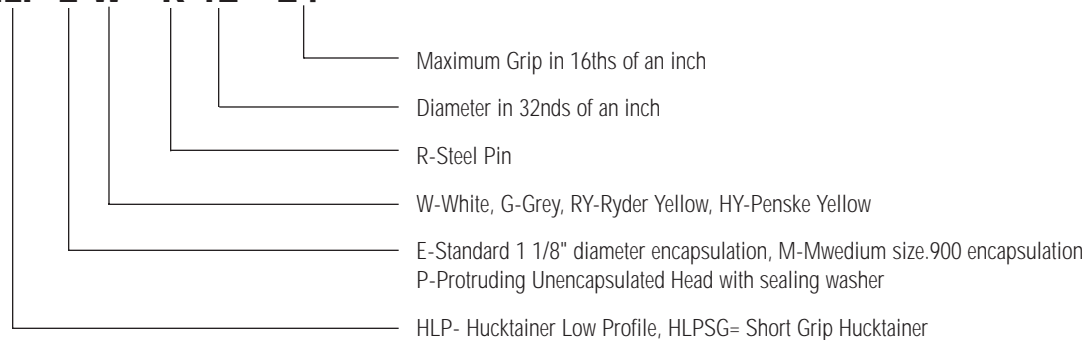

Part Number Identification - Sleeve

HLP S - R 12

